

FLOOR PLANS





Disclaimer: Area in square and cubic meters is approximate based on the architectural drawings only. All information contained herein is subject to change without notice and without liability on the part of the developer. The developer is not responsible for any errors or omissions in this document. The developer is not responsible for any errors or omissions in this document. The developer is not responsible for any errors or omissions in this document. The developer is not responsible for any errors or omissions in this document.

The Developer reserves the right to make changes to the architectural drawings without notice.



1 BEDROOM RESIDENCES

STUDIO Typical layout

Type A Floors 1 - 12

Area	346.81
Interior area	74.29
Balcony area	42.84
Net area	

STUDIO Typical layout

Type 1a Floors 1 - 10

Area	356.85
Interior area	84.57
Balcony area	442.81
Net area	

STUDIO Typical layout

Type B Floors 2 - 12, 14 - 24

Area	452.77
Interior area	192.34
Balcony area	562.81
Net area	



The developer reserves the right to alter the floor plan and specifications subject to approval from the developer at any time.



Disclaimer: All images and specifications are provided for illustrative and reference purposes only. All dimensions are provided for reference only and are subject to change without notice and without liability. The developer reserves the right to alter the floor plan and specifications subject to approval from the developer at any time.



The developer reserves the right to alter the floor plan and specifications subject to approval from the developer at any time.



Disclaimer: All images and specifications are provided for illustrative and reference purposes only. All dimensions are provided for reference only and are subject to change without notice and without liability. The developer reserves the right to alter the floor plan and specifications subject to approval from the developer at any time.

1 BEDROOM

Typical layout

Type A	Floors 1 - 17
Suit	
Interior area	438.29
Balcony area	215.51
Net area	653.8

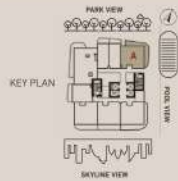

1 BEDROOM

Type 1A	Floors 2 - 26
Suit	
Interior area	635.07
Balcony area	263.93
Net area	899.0

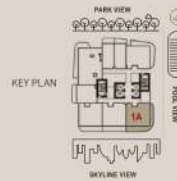

1 BEDROOM

Type 2A	Floors 18 - 26
Suit	
Interior area	756.14
Balcony area	287.86
Net area	1044.0

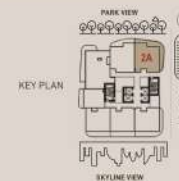

1 BEDROOM

Type B	Floors 2 - 17, 19 - 26
Suit	
Interior area	438.72
Balcony area	191.99
Net area	630.71

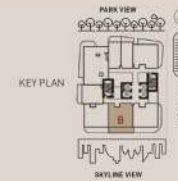



The Developer reserves the right to alterations to the above floor specifications in order to improve development efficiency.



Developer map images and visualizations contained herein are provided for illustrative and marketing purposes only. All information contained herein is subject to change without notice and without liability to the Developer or its agents. The Developer reserves the right to make corrections, deletions, additions, and other changes to this information at any time without notice. The Developer reserves the right to make corrections, deletions, additions, and other changes to this information at any time without notice. The Developer reserves the right to make corrections, deletions, additions, and other changes to this information at any time without notice.

1 BEDROOM

Type C Floors 2 - 11, 19 - 26

Unit
Interior area 444.22
Balcony area 363.0
Net area 807.22

KEY PLAN



1 BEDROOM

Typical layout

Type D Floors 11 - 17, 19 - 26

Unit
Interior area 742.39
Balcony area 118.42
Net area 860.81

KEY PLAN





2 BEDROOM
RESIDENCES



The Developer reserves the right to adjust the floor plan subject to approval from respective regulatory authorities.



Disclaimer: All images and illustrations contained herein are provided for illustrative and marketing purposes only. All dimensions contained herein are subject to change without notice and without liability on the part of the Developer. The floor plan and the space diagram are provided for reference only. The Developer reserves the right to alter the floor plan and the space diagram at any time without notice. The Developer reserves the right to alter the floor plan and the space diagram at any time without notice. The Developer reserves the right to alter the floor plan and the space diagram at any time without notice. The Developer reserves the right to alter the floor plan and the space diagram at any time without notice.

2 BEDROOM Typical layout

Type A	Floors 2 - 10, 19 - 22
Unit #	
Interior area	1022.83
Balcony area	276.92
Net area	1300.25

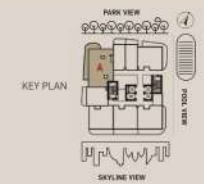

2 BEDROOM

Type 1A	Floors 20 - 24
Unit #	
Interior area	1028.83
Balcony area	276.92
Net area	1305.37





3 BEDROOM
RESIDENCES



The Developer reserves the right to alter the floor plan or specifications subject to approval from the relevant government authorities.



The architect does not guarantee that the information provided for illustration and marketing purposes only. All dimensions contained herein is subject to change without notice and without liability and does not constitute an offer to sell. The Developer reserves the right to alter the floor plan or specifications subject to approval from the relevant government authorities. The Developer reserves the right to alter the floor plan or specifications subject to approval from the relevant government authorities. The Developer reserves the right to alter the floor plan or specifications subject to approval from the relevant government authorities. The Developer reserves the right to alter the floor plan or specifications subject to approval from the relevant government authorities.

3 BEDROOM

Type A	Floor 1
Unit	349
Interior area	1047.43
Balcony area	432.59
Net area	1479.47

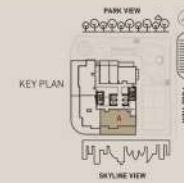

3 BEDROOM

Type B	Floor 1
Unit	1268
Interior area	1268.42
Balcony area	1029.15
Net area	2307.57

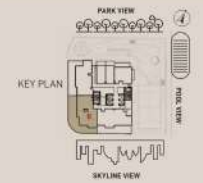



Disclaimer: Any images and specifications (including finishes) are provided for illustrative and marketing purposes only. All measurements (including finishes) are subject to change without notice and without liability. All drawings are prepared to the best of our knowledge and belief. The Developer reserves the right to make changes to the drawings and specifications without notice. The Developer reserves the right to make changes to the drawings and specifications without notice. The Developer reserves the right to make changes to the drawings and specifications without notice. The Developer reserves the right to make changes to the drawings and specifications without notice.

3 BEDROOM

Type C	Floor 1
Soft	
Interior area	1013.43
Balcony area	719.73
Net area	1733.17

