

THREE WORLDS  
ONE ADDRESS

one  
RAK  
*central*

AT

RAK CENTRAL

BY

بانتيون  
PANTHEON  
DEVELOPMENT



WHERE THE SUN, SEA AND  
SPACE COME TOGETHER.









Welcome to One RAK Central

# A NEW ERA OF LIVING!







## Introduction

Nestled in the heart of **RAK Central**, just 6 min from the pristine **Marjan Island**, **One RAK Central** offers more than just a home - it's a seamless blend of **luxury, serenity, and convenience**.

This landmark development by Pantheon Development is designed to elevate your living experience by bringing together three worlds: the calming beauty of nature, the pride of ownership, and the elegance of modern design.



A full-page background image of a sunset over the ocean. The sun is a bright, glowing orb in the upper center, with long, wispy rays of light extending across the sky. The sky transitions from a pale blue at the top to a vibrant orange and yellow near the horizon. The ocean in the foreground is a deep blue with gentle, white-capped waves rolling in.

**A WORLD DEFINED  
BY NATURAL ELEMENTS**



## The First World

**Where the Sun, Sea and Space create a Life of Tranquility.**

Imagine waking up to the golden glow of the sunrise, with unobstructed views of the calming sea and the vast open spaces that define One RAK Central

Here, nature is not just a backdrop -it's an essential part of your everyday life.







One RAK Central is located in Ras Al Khaimah's newest Business Hub, offering a prime location just 6 minutes from Marjan Island.

With close proximity to the world's largest Wynn Casino, pristine beaches, and world-class resorts, One RAK Central provides a lifestyle of unmatched luxury and convenience.

## Location Highlights

**Al Hamra Mall**  
3 Minutes

**Wynn Casino**  
5 Minutes

**Al Hamra Marina &  
Yacht Club**  
5 Minutes

**Ras Al Khaimah  
Corniche**  
15 Minutes

**Ras Al Khaimah  
International Airport**  
25 Minutes

**Sharjah  
International Airport**  
35 Minutes

**Dubai  
International Airport**  
45 Minutes



# Project Location





A WORLD OF PRESTIGE  
AND BELONGING!







## The Second World

### Where Passion Meets Privilege in Every Aspect of Life.

At One RAK Central, you don't just live - you belong. This is a world where luxury is more than just a word; it's a lifestyle. A lifestyle where passion, pride, and privilege are at the heart of everything we do.

From the carefully curated spaces to the attention to detail in every corner, One RAK Central reflects the aspirations of those who seek more.





Lobby





Infinity Pool





Sky Garden





one  
cinema

Outdoor Cinema





Kids Play Area





BBQ





Zen Garden





NO PAIN  
NO GAIN

GYM





Theatre



# Additional Amenities

Unobstructed sea views with 25+ Amenities



Rooftop Infinity Pool



Outdoor Cinema



Zen Garden



Basket Ball



Sunken Seating Pool



Sky Yoga



Mini Golf



Sky Lounge



Padel Court



Dog Park



Jacuzzi



BBQ Area







Living Room





Living Room





Bedroom



## Overview

### Luxury Living in Intimate, Thoughtfully Designed Towers.

One RAK Central brings luxury living and innovative workspaces to a mid-rise development thoughtfully designed to foster community and connection.

The three development - 02 residential and one commercial - are a perfect blend of contemporary design, convenience, and modern living, all within the dynamic environment of RAK Central.





# **RAS AL KHAIMAH THE MODERN COMMUNITY**





# THOUGHTFULLY DESIGNED RESIDENCES

Modern Floor Plans Tailored for Every Lifestyle

---

One RAK Central offers a variety of thoughtfully designed residences to suit different lifestyles and preferences.

From cozy studios perfect for urban professionals to spacious 2-bedroom apartments ideal for families, each unit is carefully planned to maximize space, comfort, and style. With open layouts, high-quality finishes, and large windows that let in natural light, every home at One RAK Central is crafted to elevate your living experience.



WYNN

Project Floor Plan - Level 4

SEA VIEW

GOLF VIEW



PARK VIEW

UNIT LEGEND

- STUDIO TYPE A
- STUDIO TYPE B
- 1 BEDROOM TYPE A
- 2 BEDROOM TYPE B



WYNN

Project Floor Plan - Level 5-16

SEA VIEW

GOLF VIEW



PARK VIEW

UNIT LEGEND

- |                  |                  |                  |                  |
|------------------|------------------|------------------|------------------|
| STUDIO TYPE A    | STUDIO TYPE B    | 1 BEDROOM TYPE A | 2 BEDROOM TYPE A |
| 2 BEDROOM TYPE B | 2 BEDROOM TYPE C |                  |                  |



WYNN

Project Floor Plan - Level 17

SEA VIEW

GOLF VIEW

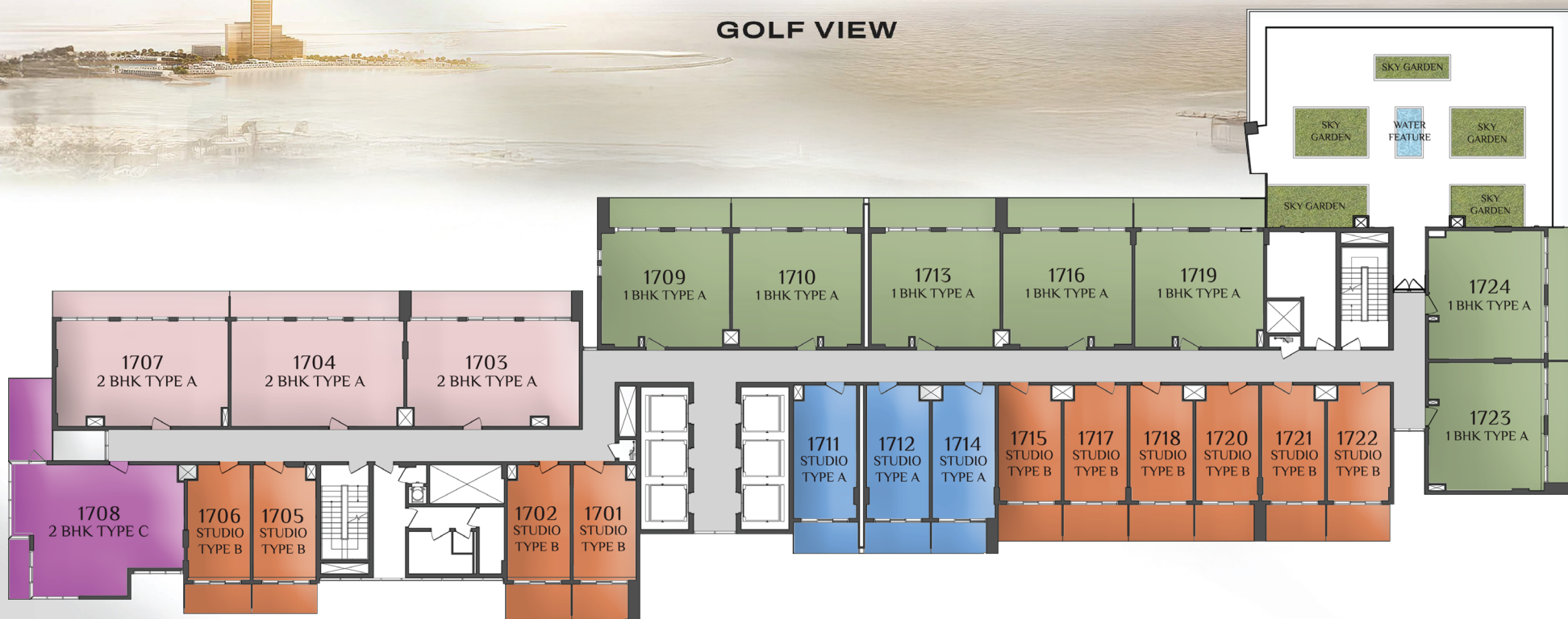

UNIT LEGEND

- |                  |               |                  |                  |
|------------------|---------------|------------------|------------------|
| STUDIO TYPE A    | STUDIO TYPE B | 1 BEDROOM TYPE A | 2 BEDROOM TYPE A |
| 2 BEDROOM TYPE C |               |                  |                  |



WYNN

Project Floor Plan - Level 18





SEA VIEW

GOLF VIEW



PARK VIEW

UNIT LEGEND

- |  |   |  |  |
|--|---|--|--|
|  STUDIO TYPE A    |  STUDIO TYPE B |  1 BEDROOM TYPE A |  2 BEDROOM TYPE A |
|  2 BEDROOM TYPE C |   |  |  |



WYNN

Project Floor Plan - Level 19

SEA VIEW

GOLF VIEW

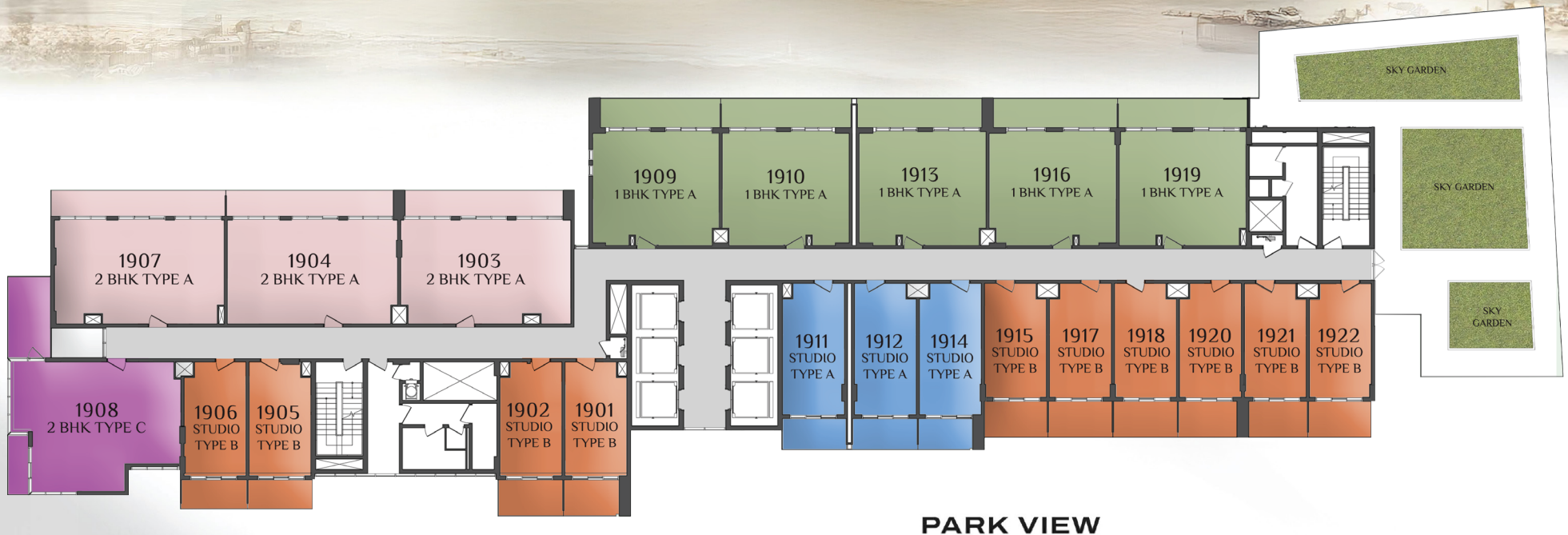

PARK VIEW

UNIT LEGEND

- STUDIO TYPE A
- STUDIO TYPE B
- 1 BEDROOM TYPE A
- 2 BEDROOM TYPE A
- 2 BEDROOM TYPE C



بـانـثـيـون  
**PANTHEON**  
DEVELOPMENT

Corporate Office

Lamborghini Building, 1st Floor,  
Sheikh Zayed Rd, Umm Al Sheif,  
Dubai

[www.pantheondevelopment.ae](http://www.pantheondevelopment.ae)